



NH1gPV 1100V DC 40A-250A Photovoltaic Fuse 光伏熔断器



Standard/ 标准: IEC 60269-6, GB/T 13539.6

INTERRUPTING CAPACITY 分断能力:

50,000 A at 1100V DC (Time Constant:1-3ms)

Dimensions/ 尺寸:

Unit 单位: mm

Type:NH1gPV Part No.: 1gPV(amp rating)U11A/A2

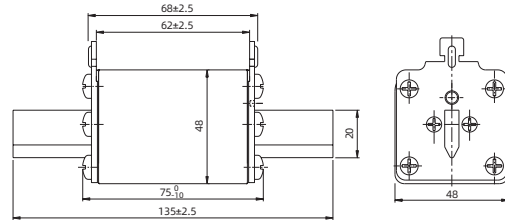

Type:NH1gPV-B Part No.:1gPV(amp rating)U11B

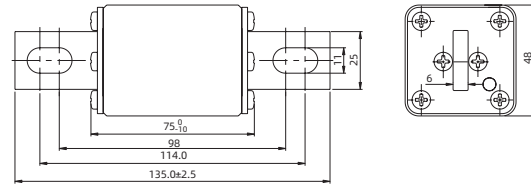

Type:NH1gPV-B Part No.: 1gPV(amp rating)U11BC

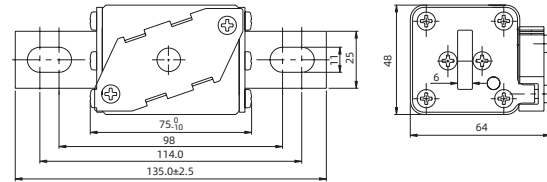

TECHNICAL PARAMETERS/ 技术参数:

PART NO. 目录编号	CURRENT RATING 额定电流	SAFETY APPROVALS 安全认证	
		TUV	
1gPV40U11A/A2	40A	●	●
1gPV40U11B/BC	40A	●	●
1gPV50U11A/A2	50A	●	●
1gPV50U11B/BC	50A	●	●
1gPV63U11A/A2	63A	●	●
1gPV63U11B/BC	63A	●	●
1gPV80U11A/A2	80A	●	●
1gPV80U11B/BC	80A	●	●
1gPV100U11A/A2	100A	●	●
1gPV100U11B/BC	100A	●	●
1gPV125U11A/A2	125A	●	●
1gPV125U11B/BC	125A	●	●
1gPV160U11A/A2	160A	●	●
1gPV160U11B/BC	160A	●	●
1gPV200U11A/A2	200A	●	●
1gPV200U11B/BC	200A	●	●
1gPV225U11A/A2	225A	●	●
1gPV225U11B/BC	225A	●	●
1gPV250U11A/A2	250A	●	●
1gPV250U11B/BC	250A	●	●

- A- 触刀安装带中央指示器 blade contacts with the center indicator
- A2- 触刀安装带中央指示器和顶部指示器 blade contacts with the central indicator and the top indicator
- B- 螺栓连接 bolted connections
- BC- 螺栓连接带微动开关底座 bolted connections with microswitch base
- A、A2-Optional 可选择
- B、BC-Optional 可选择
- U11 DENOTES FOR 1100V DC
- U11 表示 1100V DC
- DENOTES FOR APPROVAL
- 表示已取得安全认证
- DENOTES FOR PENDING
- 表示正在申请安全认证

ELECTRICAL CHARACTERISTICS/ 电气特性:

Rating 额定	CONVENTIONAL TIME(H) 约定时间	CONVENTIONAL CURRENT 约定电流	
		CONVENTIONAL NON-FUSING CURRENT(A) 约定不熔断电流	CONVENTIONAL FUSING CURRENT(A) 约定熔断电流
In ≤ 63	1	1.13In	1.45In
63<In ≤ 160	2	1.13In	1.45In
160<In ≤ 250	3	1.13In	1.45In

PART NO. 目录编号	Optional Accessory 可选配件	
	Fuse Holders 熔断器座	Microswitches 微动开关
1gPVXXXU11A	NH1BU11	/
1gPVXXXU11A2	NH1BU11	HMT-01
1gPVXXXU11BC	/	HMC-01

NH1gPV 1100V 平均 I-T 曲线图 (仅供参考)

AVERAGE I-T CHARACTERISTICS CURVE
(FOR REFERENCE ONLY)

